

CRIME PREVENTION THROUGH ENVIRONMENTAL DESIGN NOTES:

1. REFER TO THE ACCOMPANYING CPTED NARRATIVE FOR ADDITIONAL INFORMATION AS TO HOW THE CPTED PRINCIPLES ARE BEING IMPLEMENTED FOR THIS PROJECT.
2. THIS PROJECT WILL INCORPORATE A CCTV CAMERA SECURITY SYSTEM. CAMERA LOCATIONS WILL BE DETERMINED BASED ON THE RECOMMENDATIONS OF THE SECURITY CONSULTANT AND CONSULTATION WITH THE BSO DURING BUILDING PERMIT REVIEW.
3. SECURITY CAMERA LOCATIONS AND DIRECTIONS ARE APPROXIMATE AND ARE SUBJECT TO CHANGE. A BUILDING PERMIT APPLICATION WILL BE SUBMITTED FOR THE INSTALLATION OF THIS SECURITY SYSTEM. DETAILED PLANS SHOWING "CONES OF COVERAGE" SHALL BE PROVIDED AT TIME OF BUILDING PERMIT SUBMISSION.
4. ALL EXTERIOR ELECTRICAL POWER OUTLETS WHICH ARE LOCATED IN UNSECURED AREAS WHICH ARE ACCESSIBLE TO THE PUBIC WILL HAVE A LOCKING MECHANISM AND/OR POWER SECURE INTERNAL CUTOFF SWITCH TO DENY UNAUTHORIZED USE. REFER TO ARCHITECTURAL PLANS FOR DETAILS.
5. CLEAR SIGHT VIEWS, ACTIVITY NODES, AND PROPERTY MAINTENANCE WILL PROVIDE NATURAL SURVEILLANCE AND POLICING OF THE AREAS ADJACENT TO THE BUILDING FACADE, INCLUDING ADJACENT PUBLIC SIDEWALKS. STOREFRONT WINDOWS WILL NOT BE OBSTRUCTED AND CLEAR VIEWS WILL BE MAINTAINED TO THE EXTERIOR AT ALL TIMES.
6. EMERGENCY ACCESS WILL BE PROVIDED FOR LAW ENFORCEMENT. THERE IS NO GATED ENTRY TO THE MAIN ENTRANCE.
7. REFER TO LANDSCAPE PLANS FOR PROPOSED LANDSCAPE TYPE, NAMES, QUANTITIES, AND MAINTENANCE NOTES.
8. ALL HEDGES, BUSHES, LOW PLANTS, AND GROUND COVER SHALL BE MAINTAINED AT A MAXIMUM OF 30" IN HEIGHT (REFER TO LANDSCAPE PLANS FOR ADDITIONAL DETAILS AND MAINTENANCE NOTES).
9. CANOPY TREES AND PALMS SHALL ME MAINTAINED WITH AN 8" CLEAR TRUNK (REFER TO LANDSCAPE PLANS FOR ADDITIONAL DETAILS AND MAINTENANCE NOTES).
10. "NO TRESPASSING" SIGNAGE, IN ACCORDANCE WITH BROWARD COUNTY'S NO TRESPASSING PROGRAM, SHALL BE IMPLEMENTED AT THE MAIN ENTRANCE AND AROUND THE COMMON AREAS OF THE SITE. SIGNS SHALL BE POSTED IN CLEAR VIEW AND FASTENED SECURELY AT ALL CORNERS.
11. KEY SECURITY: ACCESS CONTROL AND SECURITY STRENGTHENING.
 - 11.1. AN ACCESS KEY CONTROL SECURITY SYSTEM WILL BE IMPLEMENTED CONSISTING OF AT A MINIMUM A KEY STORAGE SAFE IN A DESIGNATED AREA WITHIN THE MANAGEMENT OFFICE.
 - 11.2. KEY SECURITY OFFICE/ ROOM/ KEY STORAGE CLOSET DOOR SHALL HAVE AN ALARM AND MECHANICAL LOCKING SYSTEM.
 - 11.3. A SURVEILLANCE CAMERA SHALL BE ASSIGNED TO MONITOR THE OFFICE KEY STORAGE AREA AT ALL TIMES.
 - 11.4. MANAGEMENT OFFICE DOOR SHALL HAVE A SECURITY VIEWER (PEEPHOLE) OR A REINFORCED SECURITY WINDOW.
12. ELECTRONIC SURVEILLANCE - SECURITY STRENGTHENING: PROPOSED CAMERA AND MONITORING LOCATIONS WILL BE COORDINATED WITH A SECURITY AND ACCESS CONTROL CONSULTANT AND THE BROWARD SHERIFF'S OFFICE CPTED REVIEWER *** PRIOR *** TO PERMITTING. PLANNING AND INSTALLATION OF THE SURVEILLANCE MONITORING SYSTEM SHALL INCLUDE FIELD INPUT FROM AN EXPERIENCED CPTED/SECURITY STRENGTHENING LAW-ENFORCEMENT OFFICIAL TO ENSURE OPTIMAL RESULTS.

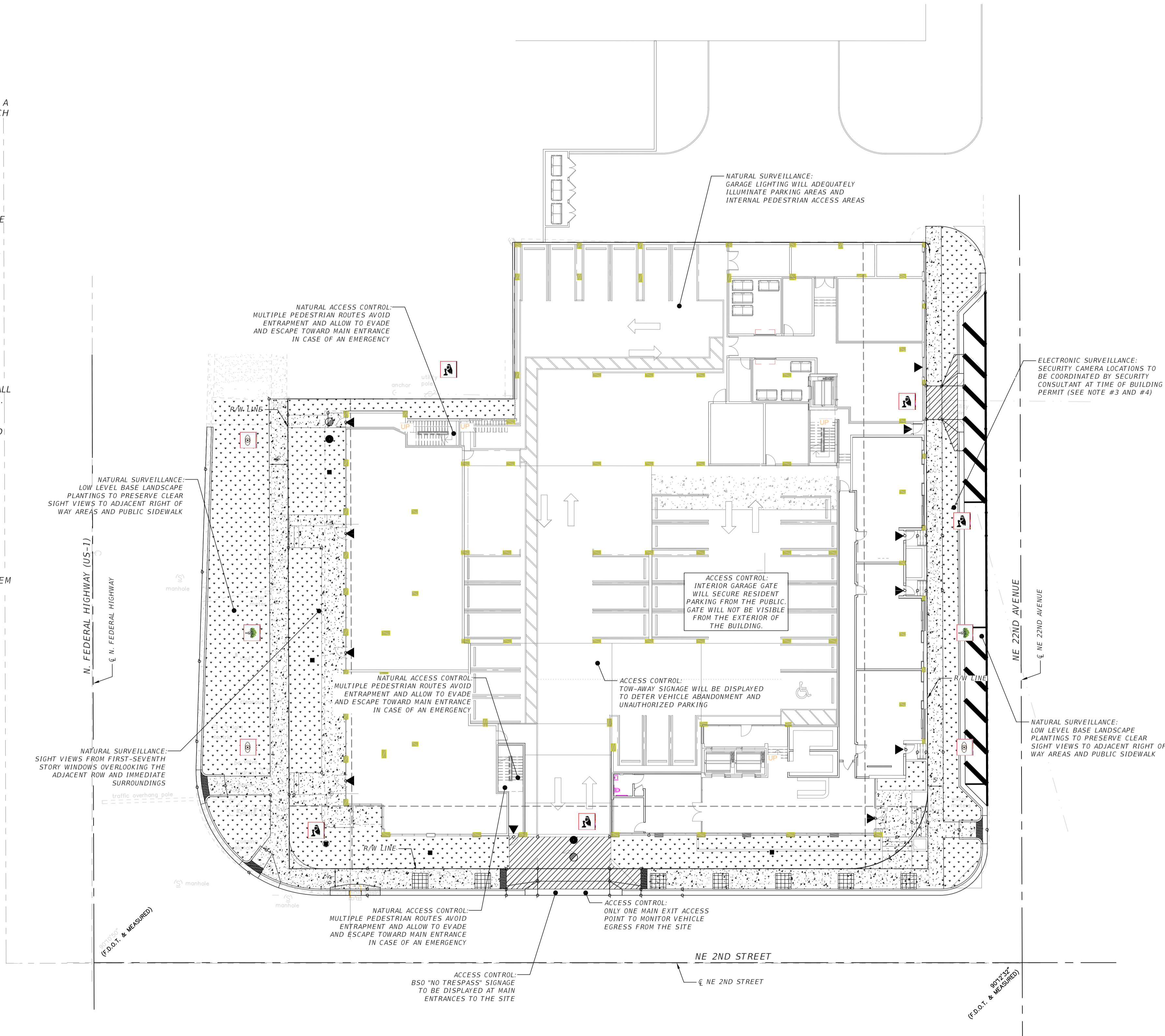

LEGEND			
	M: MAINTENANCE		SE: SURVEILLANCE - ELECTRONIC
	ACN: ACCESS CONTROL - NATURAL		AS: ACTIVITY SUPPORT
	TR: TERRITORIAL REINFORCEMENT		TR: TERRITORIAL REINFORCEMENT
	SE: SURVEILLANCE - NATURAL		

AAC
PZ23-12000052
04/02/2024

PLAN REVISIONS

DATE

200 NORTH
200 NORTH FEDERAL HIGHWAY
POMPANO BEACH, FL 33062

CMPLX LLC
2140 S. DIXIE HIGHWAY, SUITE 308
MIAMI, FL 33133
T: 786.258.0786
WWW.CMPLXWORLD.COM

Michael D
Gonzalez
2023.11.10
16:22:32-05'00"

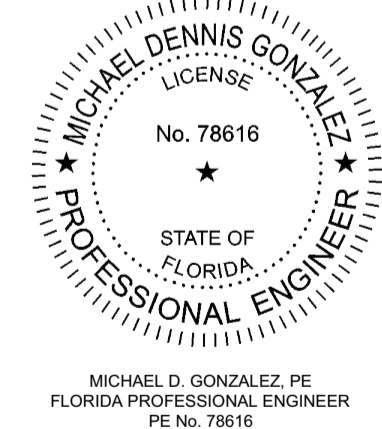

THIS ITEM HAS BEEN DIGITALLY SIGNED AND SEALED BY
MICHAEL D. GONZALEZ, P.E.
ON THE DATE ADJUNCT TO THE SEAL
PRINTED COPIES OF THIS DOCUMENT ARE NOT CONSIDERED SIGNED AND SEALED AND THE
SIGNATURE MUST BE VERIFIED ON ANY ELECTRONIC COPIES

PRELIMINARY
CPTED PLAN
(GROUND LEVEL)

C-3

SHEET 3 OF 5